



Rector

The Benefice of Bentley, Binsted & Froyle

to be joined by Kingsley with Oakhanger subject to the approval of the Deanery Reorganisation

In the deanery of Alton





INDEX

| | |
|---------|------------------|
| 4 - 5 | Welcome |
| 6 | Introduction |
| 7 | Our Vision |
| 8 - 9 | Our Church Life |
| 10 | Our Team |
| 11 - 12 | Role Description |
| 13 - 17 | Our Churches |
| 19 | Our Schools |
| 20 - 21 | Our Finances |
| 22 | The House |
| 23 | Appendix |

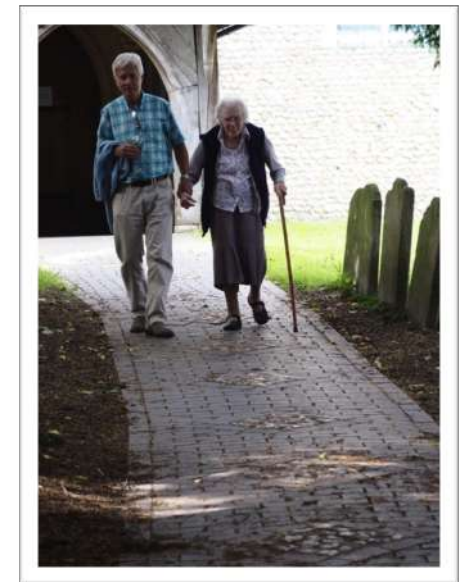

WELCOME

Welcome to this Benefice Profile and Role Description ... and welcome to the Diocese of Winchester!

At the heart of our life here is a desire to be always Living the Mission of Jesus. We are engaged in a strategic process to deliver a mission-shaped Diocese, in which parochial, pastoral and new forms of pioneering and radical ministry all flourish. Infused with God's missionary Spirit we want three character traits to be clearly visible in how we live:



David Williams
Bishop of Basingstoke

- ✦ Passionate personal spirituality
- ✦ Pioneering faith communities
- ✦ Prophetic global citizens

We pray that, if God is calling you to join us in his mission in this part of the world, he will make his will abundantly clear to you.

'As the Father sent me so I send you ... Receive the Spirit.' John 20:21

Read more about [Winchester Mission Action Planning](#) here.



Alton Deanery

Alton Deanery comprises 23 church buildings and 18 parishes, gathered around and including the market town of Alton. There are currently five Benefices but, pending the planned completion of a Diocesan Reorganisation, this number would reduce to four.

A prime focus within the Deanery is our Mission Action Plan, which we regard as constant work in progress, and via which we are seeking to:

- Develop and enthuse lay leaders;
- Engage with schools in the Deanery (Primary and Secondary, Church and 'State') to develop the faith and prayer of their pupils and families;
- Encourage Fresh Expressions and the planting of new congregations, as we explore how best to offer a breadth of worship across the Deanery;
- Work collaboratively, e.g. offering Christian Explorer & Community Support courses such as Alpha, Marriage Prep, Parenting.



Individuals, and each Benefice, offer opportunities to share gifts to equip and build up the whole people of God for mission and ministry.

Chapter meetings are usually held whilst sharing a light lunch, bringing an emphasis on support and encouragement of one another, and also, spending time together with the Bible and in prayer.

Being Area Dean, but without the responsibility of a parish, does allow me to be available both on Sundays to cover services, as well as Occasional Offices, and to offer support to the Deanery clergy.

You, and the parishes, are in my prayers at this time of discernment.

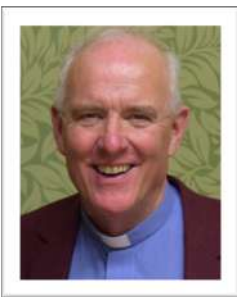

Brian Pritchard
Area Dean of Alton

INTRODUCTION

Thank you for your interest in this role of the Rector of our Benefice which lies in the Alton Deanery. This vacancy arises as the previous post holder, after eleven years in this Benefice and having in his words 'been so blessed over this period and personally inspired by the great team of staff and volunteers', felt both called by God to a new challenge and that the Benefice would benefit from the inspiration and fresh perspective of a new Incumbent.

The current Benefice of three parishes, Bentley, Binsted and Froyle, (www.benbinfro.co.uk) is thriving and, subject to the approval of the proposed Diocesan Reorganisation, will be joined by the parish of Kingsley with Oakhanger. The Benefice is working towards becoming a single parish, which has been agreed in principle and now awaits the issue of the draft scheme of arrangement. It is anticipated that the timescale for this will enable the inclusion of the additional parish of Kingsley with Oakhanger as part of the Diocesan Reorganisation. Pending completion of the Diocesan Reorganisation, it has been agreed that the Bentley, Binsted and Froyle Benefice will take informal responsibility for Kingsley with Oakhanger parish, which has huge potential and will provide exciting opportunities for our church community.

These four rural parishes are located in the beautiful countryside of northeast Hampshire on the Hampshire/Surrey border between the market town of Alton (www.alton.gov.uk), the expanding new eco-town of Whitehill and Bordon (www.whitehilltowncouncil.gov.uk) and the Georgian town of Farnham (www.farnham.gov.uk). The A31 runs through the Benefice providing easy access to both the M3 and A3. Bentley Station provides a direct line to London Waterloo taking about 1 hour.

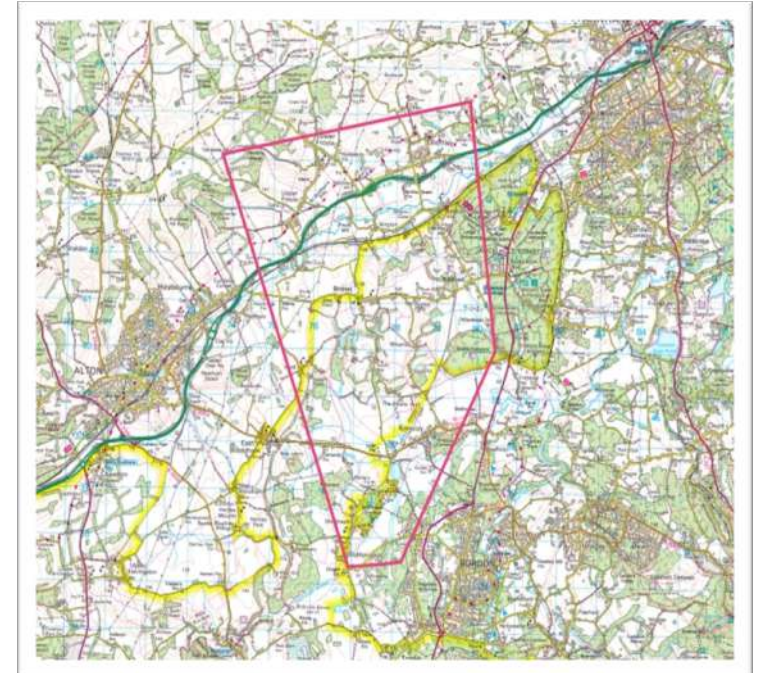

Red line roughly depicts the proposed Benefice boundary.
Yellow boundary depicts the South Downs National Park



The parishes are all traditional English villages with the church as a focal point. Their origins were in farming, forestry and hop growing. These days many families with young children have moved into the villages attracted by two village schools, whilst commuting to work further afield. It is an area of natural beauty, and the villages are in the South Downs National Park (www.southdowns.gov.uk) or on its verges. The area also attracts many retired people wanting to live in the country but within easy reach of London.

The vicarage is in Binsted which is centrally situated in the Benefice.

There are several wedding venues in the Benefice and our churches are popular for weddings. Many come from far afield, including from London, to have their special day here.

OUR VISION

We are a thriving Benefice with a non-stipendiary Assistant Priest, a retired Honorary Assistant Minister, Anna Chaplain, Pastoral Assistant (Worship), Pastoral Assistant (Youth), Operations Manager and lay team that is mutually supportive, with parishes that are collaborative while retaining individuality, believing in unity without uniformity. We are fortunate that our Youth and Worship Pastoral Assistants and Anna Chaplain are funded entirely from donations.

Our vision is to be a welcoming, supportive and growing Christian family, that is fully integrated in the wider community of which we are part but evolving to reflect continuing demographic and social changes while fully supporting the deanery, diocese, and the needs of the wider world.

The current Benefice is growing and developing its activities and works well together in terms of attendance and in the depth of our spiritual lives across the four parishes.

Looking to the future, we would like the new Rector to:

- Be a prayerful leader and led by the Holy Spirit able to discern and implement God's vision for our Benefice.
- Be an able preacher whose ministry is marked by teaching the whole Bible and empowers discussion in homegroups.
- Bring their experiences and skills to develop and encourage the Benefice and, whilst recognising the differences between the churches, able to draw the churches together.
- Be sensitive and flexible to the needs of the community, in particular with the return to the new 'normal' post the pandemic.
- Maintain the important links with the two Church of England schools within the Benefice and participate in and/or lead the weekly school assemblies and pro-actively support these as a Foundation Governor.
- Continue to work alongside our wonderful youth workers in support and encouragement as they grow the young people from across the Benefice, from pre-schoolers through to confirmation and beyond, in their walk with Christ. To assist these leaders in growing Christ's mission in the Benefice.
- Further enhance all that has successfully been achieved here in the Benefice as well as carrying out new initiatives to encourage pastoral care and each parishioner's Christian journey. To encompass and build on this foundation with Kingsley with Oakhanger.
- Continue and develop our churches, making them ever more relevant to daily life through involvement in and with our wider village communities.
- Generate and encourage a desire and support for mission, especially within Kingsley with Oakhanger.
- Grow and develop our lay leaders.
- Develop, encourage, and embrace the gifts that people can give – time, practical skills, money, expertise, lay ministry. Draw more of our gifted people into licensed and authorised ministry.
- Continue to expand our scope with ministry with older people through the Anna Chaplain and Anna Friends.



OUR CHURCH LIFE

Our priority as a Benefice is to continue to be deeply committed to working together and to build on this unity, love, and support for each other. This is a witness to our community which will draw people into our Christian lives.

Being a welcoming Church to everyone is very important to us in the life and mission of our parishes and in our services, we do cater for a wide variety of preferences. We offer the Eucharist every Sunday within the Benefice and a range of services from BCP Holy Communion, more modern but still traditional Holy Communion through to informal lay-led Morning Worship, Sung Evensong supported by the Benefice-wide choir, to All Age Worship at Live@5, a contemporary late afternoon service accompanied by a growing worship group which includes some of our youth.

Over the past few years, the Benefice has naturally grown together, whilst our churches have maintained their individuality with their own flavour of regular services. Some other events and activities have become centralised within the existing Benefice.

CURRENT ORGANISATION

- Rectors' council, consisting of the Ministers and Churchwardens, provides direction of service patterns and activities to PCCs and meets quarterly.
- Centralised administrative team, consisting of 2 part-time paid administrators and a volunteer Operations Manager, who between them are in the Benefice office located in Bentley Church Hall for two and a half days each week.
- Church Organists share the playing at services across the Benefice.

MORE THAN CHURCH SERVICES

- **THOSE IN OUR CARE HOMES.** Anna Chaplain and lay Anna Friends ministering in the two Care Homes and to other elderly in their own homes throughout the Benefice. The Eucharist is taken into the care homes and to those who are housebound, during non-Covid times.
- **YOUNG PERSONS.** Youth work, led by our two employed youth and worship leaders, who are each employed for 25 hours per week, including small groups, our four:twelve youth club, Youth Alpha, Messy Church, and School Assemblies.
- **HOME GROUPS.** Members are typically drawn from across the Benefice rather than one parish church. We have around 100 attendees across 9 home groups, each with designated leaders, which are co-ordinated by the Assistant Priest.
- **PRAYER.** Benefice prayers every Monday with other prayer meetings during the week. We have a Benefice Prayer chain for urgent prayer needs.
- **BELL RINGERS.** Bentley, Binsted and Froyle are fortunate to have bell towers and teams of enthusiastic and active bell ringers. The bells are rung for Sunday services, weddings, and special events such as Christmas and New Year, and in Binsted and Froyle for weekly practice. The bell ringing teams frequently share the work at the different churches in the Benefice. New bell ringers are encouraged, trained, and always welcomed, as are visiting bell ringers.



The BenBinFro Benefice Anna Friends

ON-LINE PRESENCE

The Benefice website (www.benbinfro.co.uk) is actively managed and frequently updated. Our on-line presence increased enormously due to the pandemic and continues. Other activity on-line is on our YouTube channel (www.youtube.com/channel/UCTcZ1SJQ3gXKhRC0F0bFa_Q) and includes:

- Daily 'Thoughts for Today', an on-line Bible reading and reflection, mainly lay led using a rota of almost 30 persons from across the Benefice. An example is at: www.youtube.com/watch?v=I4WuLa9RSSU.
- A Weekly on-line service published or streamed every Sunday. An example is at: www.youtube.com/watch?v=eXUVh3sYB34.
- On-line specials such as the Real Nativity and an Advent Calendar. The Real Nativity for 2020 (www.youtube.com/watch?v=IBKXXIXVs0) has had nearly 1,800 views. An example of an Advent Calendar video for 2021 is at: www.youtube.com/watch?v=odzPSYBfCi8.
- During lockdown School Assemblies were on-line, for example: https://www.youtube.com/watch?v=C_l1fADEtCw

ANNUAL EVENTS

- The churches participate in the annual village fetes by running large church stalls.
- Annual outdoor services held in Marquees following the village fetes.
- A Passover meal held every Maundy Thursday.
- The "Real Nativity" with live donkeys and sheep along with a cast of many from the Benefice, in period costume, moving between Church, nearby cottages and neighbouring barn retelling the nativity story.
- Rogation walks, Easter activities for the children, Harvest meals and Christmas carol singing.
- A group from the Benefice camp for a week at New Wine each summer.



SPECIAL EVENTS

- Confirmation service every two years.
- Occasional Men's and Ladies Breakfasts with guest speakers.
- We currently typically perform 20 – 30 weddings across the Benefice annually. All couples are required to attend the Preparation for Marriage Course, led by Benefice volunteers. We warmly welcome these wedding couples into our services so that they feel part of our church community as they prepare for their special day and life together.
- Alpha courses are held for the Benefice and beyond. Recently we have held either an adult or a youth Alpha course every year, including online during the pandemic.
- Pentecost Prayer week (based on the Archbishop of Canterbury's initiative 'Thy Kingdom Come') held annually with a 24/7 Prayer Room in Bentley Church Hall and satellite prayer stations in the other churches and elsewhere in the Benefice, encouraging people to visit the various locations.
- Senior Citizen lunches or teas, typically three times a year pre-Covid.
- Biennial Benefice Weekends away at nearby conference centres with an invited external speaker, with upwards of 50 parishioners attending.
- Benefice Flower Festivals, there is one planned for June 2022 at Binsted Church, for the Queen's Platinum Jubilee celebrations.

PUBLICATIONS

- Bentley and Binsted share a church Parish magazine. Froyle has its own village magazine. Both these publications are delivered to each house in the relevant parish. Kingsley with Oakhanger is included within the King's World magazine available by subscription.

OUR TEAM

There is an active support team of the laity and churchwardens, and a growing number willing to use their skills in ministry and church organisation.



Assistant Priest
Rev Christopher Ogilvie Thompson



Ret'd Hon Ass Minister
Rev David Perryman



Anna Chaplain
Rev Nicky Smallwood



Pastoral Asst (Worship)
Sam Ball



Pastoral Asst (Youth)
& Administrator
Gemma Ball



Operations Manager
Steve Fice



Administrator
Lucinda Edwards



Churchwarden Bentley
Jill Kiely



Churchwarden Bentley
Nick Caddick



Churchwarden Binsted
Kathy Ogilvie Thompson



Churchwarden Binsted
Stella Croom Johnson

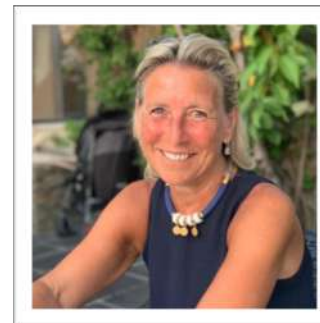

Asst Churchwarden Binsted
Liz Carey



Churchwarden Froyle
Simon Marshall

ROLE DESCRIPTION

This Role Description should be read in conjunction with the vision, aims and priorities set out in this profile. The role is for a priest who will lead, support and nurture the inhabitants of our villages; to maintain the vibrancy of the original Benefice; to continue to build and develop the mission of the churches in the enlarged Benefice whilst ensuring the pastoral needs of all are met. We envisage an experienced leader as the role carries significant oversight and strategic development responsibilities. As our Rector we are seeking someone who:

Spirituality

- Follows an ordered personal, spiritual life of daily prayer and Bible study and shares the fruits of the Spirit of their own discipleship with others.
- Seeks to follow the model given us by Jesus Christ of active ministry and time out for reflection and prayer in quiet days and retreats.
- Has a heart to teach and share the truth of the Bible in its entirety.
- Balances time with family and friends with the demands of parish life.

Worship and Preaching

- Is comfortable leading and participating in the current full range of our parish services whilst developing and enriching them further.
- Is proactive in growing our existing church congregations with active community engagement.
- Supports and encourages the ministry of lay people in leading services, in pastoral work across the Benefice and in other events.
- Through preaching and other communication, presents and interprets the Christian message in relevant and inspiring ways that encourage us to live and witness as Christians in the 21st Century.

Leadership and Collaboration

- Is a servant leader and proven team player committed to working collaboratively with the various teams in the Benefice and can lead or take a role as a team member, as appropriate.
- Is capable of managing and developing the existing staff team in their spiritual and vocational journeys.
- Is an effective delegator and decision maker and able to manage both their own workload and the load of others.
- Is a capable leader, able to chair meetings ensuring that all voices are heard and valued, ensure clear decisions are reached and implemented, and is able to help steer us towards becoming a single parish.

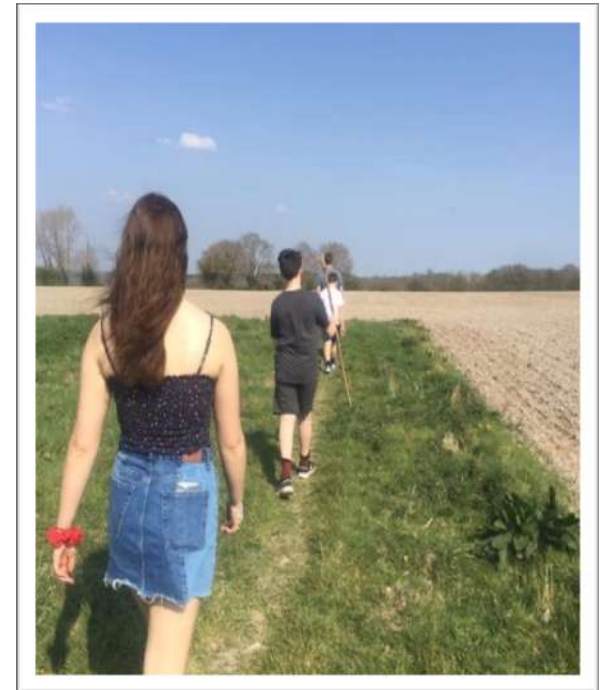

Vicarage in the background

Discipleship, Learning and Nurture

- Is open and creative in their approach to Christian discipleship and spiritual growth and is strongly committed to seeing God's people grow and mature in faith and use their gifts in God's service.
- Is prepared to lead or co-lead discipleship and nurture courses across a broad spectrum.
- Is committed to encouraging and to maintaining the growth and development of our established home groups.
- Listens and responds to the needs of the wider village communities.

Evangelism and engagement with social justice

- Is proactive and persuasive in sharing their faith with others and can enable others to gain confidence to do the same.
- Understands the imperative and breadth of outreach and mission and will work and encourage others in mission, fair trade and outreach activities.
- Is experienced in working with schools and is committed to maintaining and further developing our relationships with local schools and with young people beyond schools.

Pastoral Care

- Is approachable and sensitive to varied pastoral needs of our church family and wider community and willing to share pastoral care with our team, both ordained and lay.

Stewardship and Organisation

- Exhibits and proactively encourages generosity in the discipleship of church members in the giving of their time, talents and money.
- Brings and displays the proven ability to plan, organise, manage, communicate effectively and chair meetings with the clergy team, Churchwardens, Benefice Office personnel and schools.

Ecumenism and Links with other bodies

- Is committed to working with local churches, especially in the Alton area, and encouraging others to do so.
- Actively encourages the support of our mission partners.
- Plays an active part in Deanery (through chapter and synod) and Diocesan life.

The role description should always be read in conjunction with the [Guidelines for the Professional Conduct of the Clergy](#).

HOW TO APPLY



A full application pack, along with Terms & Conditions, is available from the Diocesan website, [here](#).

For an informal conversation about vacancies in the Winchester Archdeaconry please contact:

The Right Reverend David Williams
Bishop of Basingstoke 01962 737330
bishop.david@winchester.anglican.org

Jane Hammond
Clergy Appointments Assistant
clergy.appointments@winchester.anglican.org

OUR CHURCHES:

St Mary's Church, Bentley

St Mary's Church is sited on the northeast edge of Bentley, (bentleyparishcouncil.co.uk).

Bentley is a popular village, with a population of approximately 1,116, which has a recently refurbished shop with a Post Office, a hairdresser, a pub ('The Star Inn'), and an Indian takeaway. There is a Church of England school in the village. The civil parish is around 2,300 acres in size and consists of the village plus its immediate surrounds. There is a thriving community in the village, including a local scout group, regular coffee mornings in the pub and the Memorial Hall and a fully subscribed nursery. Regular annual events include a hugely popular Summer Fete (in 2019 almost 2,000 attended) and a popular Guy Fawkes Bonfire and Fireworks evening (in 2021 over 1,500 people attended).

St Mary's is a Grade 2* listed building dating from the 12th Century and lies to the north of the village on the St Swithun's Way, part of the ancient Pilgrim's Way between Winchester and Canterbury. The church has been added to over the centuries, especially in the Victorian period and is in good condition with only minor issues highlighted in the 2021 Quinquennial inspection. Recent upgrades have been made to the electrics, with new LED lights installed throughout the church, and a new boiler installed in late 2021. Attached to the church is the new Church Hall, which was opened by the Bishop of Basingstoke in 2015. A total of £250,000 was raised to build this. Prior to the project starting, £100,000 had been raised; the additional £150,000 was raised while the Hall was being built, through generous donations from the parish and the wider village and numerous fundraising activities.

The graveyard and car park have recently been extended and a new path from the car park to the church door has recently been added. A feature of the graveyard is a number of very ancient yew trees that line the approach to the church. Maintenance of the graveyard is undertaken on a regular weekly basis by a paid local professional gardener and is assisted by the church wardens and parties of volunteers, generally recruited through the Home Group network. The Parish Council donate regular grants towards the upkeep of the graveyard.

During the interregnum, each month there are typically two Live@5 services and two morning services, as detailed in the Appendix to this document. Pre-Covid, attendance at these services was typically 50 to 80, with increased numbers for major festivals. There are 129 on the electoral role.

For all three of the PCCs, meetings are held 5 times a year and together with a joint PCC meeting across the Benefice twice a year.

Churchwardens: Jill Kiely and Nick Caddick

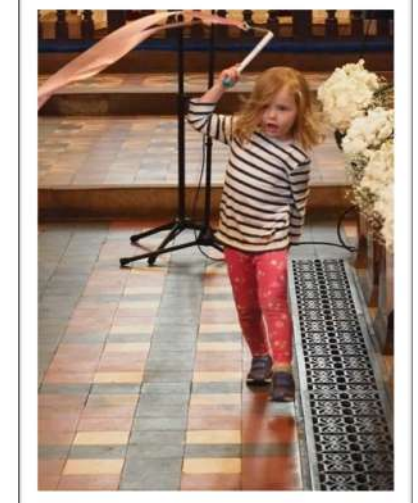

Holy Cross Church, Binsted

Holy Cross Church is situated centrally in the Benefice, in the middle of the village close to the Primary School and the recently refurbished Wickham Institute which serves as the village hall. The vicarage is next door to the church.

The church is a Grade I listed building, dating from the 12th Century, but it is believed there may have been an earlier Saxon church on or near the site. The Westcote Chapel contains an engraved monument to a local figure Richard de la Bere de Westcote. The effigy shows him clad in a surcoat of mail with his bascinet (helmet) on his head resting on a cushion raised by two angels. Local tradition has it that he was a crusader knight, although this is not proven!

The graveyard has magnificent views and contains the grave of Field Marshal Viscount Montgomery of Alamein. It is the parochial place of burial, and the Parish Council makes a substantial annual grant towards its maintenance. Many of the parishioners contribute and volunteer to maintain the Church and the Churchyard.

The Civil parish is of large extent, about 7000 acres; from the outskirts of Alton to Rowledge Church and includes much of Alice Holt Forest. (binstedparishcouncil.org.uk). The Ecclesiastical parish covers about 2/3 of the civil parish, from Malms Farm in the west to Blacknest in the east, and from Isington in the north to Wyck, South Hay, Wheatley, and Frith End in the south. These scattered hamlets make up the parish, which has a population of approximately 1,871, which has no central built-up area or concentration of population. It is still primarily rural and agricultural, with the southern part of the parish lying in the South Downs National Park.

Being a rural community, there are limited facilities in Binsted. We have a newly refurbished pub re-named 'The Binsted Inn', now with accommodation, and an organic farm shop in Isington. There is another pub at Blacknest called 'The Jolly Farmer'. The Wickham Institute is used by the community, for weekly coffee mornings, fitness classes, the church Christmas fair, community suppers and can be hired out for private functions. There are thriving cricket, tennis and croquet clubs at the Recreational Ground and a youth football team.

In recent years, a re-ordering committee has been set up to look at making provision for facilities in keeping with expectations of current society. The plans for installing lavatories are actively being pursued.

Morning services are alternated with the other parish churches and Messy church is held monthly as shown in the Appendix. There are 56 registered on the Electoral roll with an average attendance of 30 with more on major festivals.

Churchwardens: Kathy Ogilvie Thompson, Stella Croom-Johnson.

Assistant Churchwarden: Liz Carey.



St Mary's Church, Froyle

St Mary's Church is a Grade I listed building situated in the northwest part of the Benefice. (www.froyle.com).

Froyle village, with a population of around 650, is made up of two parts: Upper and Lower Froyle, which together form one civil parish and are seen as one community in social and church congregational terms.

The church is in Upper Froyle, located next to what was once the main manor house. The manor house was sold at the end of the Second World War by the last lord of the manor's estate to Lord Mayor Treloar school for disabled children, who in turn sold it on in 2012, when it was converted to its current use as a wedding venue, and the surrounding land on the other side to the church was developed as a residential estate. Despite this and other smaller scale residential developments, the civil parish remains extensively rural, comprising around 4500 acres of rolling countryside, with most of the land given to agriculture and forestry.

Many of the older buildings in Upper Froyle carry a small statue of a saint, inspired by the last lord of the manor, which has led the village to be known as "The Village of the Saints". In terms of village facilities, Froyle has two pubs - 'The Anchor' in Lower Froyle, and 'The Hen and Chicken' in Upper Froyle - and a petrol station with a small shop on the main A31 Alton to Farnham road on the edge of Upper Froyle. There is also a modern and well-equipped village hall and recreation ground in Lower Froyle which is well used by the community, for coffee mornings and other regular community events, such as an outdoor church service, quiz night, bonfire night and village fete.

The church building itself is of 14th Century origin, with major later additions, including a tower dating from 1722 and a nave that was rebuilt in 1812. The church remains much loved and well supported financially within the village by churchgoers and non-churchgoers alike. Since 2000, the roof has been renovated, the organ has been modernised, and a major facilities modernisation programme is in process: the vestry was recently (2020/21) updated with a brand-new kitchen, enabling us to host more events at the Church; a major refurbishment of the interior of the church itself is currently underway, including redecoration, rewiring and a new lighting scheme.

In terms of public worship, Froyle has a high church history associated with the family who were lords of the manor until the Second World War. That is now in the past, but is reflected in some of the artefacts in the church and in a traditional (Common Worship) approach to liturgy; also in an impressive collection of church vestments collected by the last lord of the manor from Italy and bequeathed by him to Froyle church. There is also a strong choral

tradition, with a choir drawn from across the benefice, led by a director of music, which sings at a choral Evensong service once a month, and leads the congregation in two special annual services, one at Advent and one on Maundy Thursday.

Less formally, the end of lockdown was celebrated last year by the church being converted for a time into Noah's Ark, populated by animals made by children (and others) in the village – see adjacent photos.

The normal Sunday services, in addition to Evensong, consist of an early morning Holy Communion, a Morning Eucharist, and a Morning Worship each month. There are 76 members registered on the Electoral roll with an average pre-Covid attendance of around 30, with more on major festivals.

Churchwarden: Simon Marshall



Noah's Ark – a lockdown project



The Parish of Kingsley with Oakhanger

All Saints Church, Kingsley

Kingsley is a village situated roughly 3 miles south of Binsted, with a population of approximately 620. It is a compact village with most houses being on either side of the main road running through the village. Away from the centre there are clusters of dwellings at Frith End and Sleaford to the east, and at Rookery Farm, Bakers Corner and Shortheath Common to the west and south. Kingsley is fortunate to have a shop and post office, run in the Kingsley Centre, where there is also an active Nursery, and facilities which can be hired out for village functions. Over 40 small businesses – light industrial and commercial – now use redundant farm buildings and the land formerly used by the old iron works, and towards the east end there is Country Market, a large retail centre which has twice weekly car boot sales. Another established landmark of the village is 'The Cricketers' Pub, an integral part of Kingsley's history. There is an active cricket club based at the Kingsley Sports Club, and the popular Kingsley Tennis Centre. One of the largest attractions of Kingsley is its wonderful common which draws people into the village to enjoy walking and riding. The land is owned by the MOD and is used by the Armed Forces for training so it's not uncommon to find yourself in the midst of (peaceful!) military exercises! Another very popular attraction of the common is Kingsley Pond, owned by Oakhanger Angling Club, which provides some of the best fishing around.



Kingsley's original church was St Nicholas Church and cemetery, whose history is believed to go back to the 12th century. But in 1876 All Saints Church was built, (now a Grade 2 listed building) in a prominent position in the heart of the village. In the 1980s it was decided that the village could only support one church, and so St Nicholas' Church, being the furthest away from the centre of the village, and the smaller of the two churches, was decommissioned and is now run by the Parish Council. In 2012 the Parish Council obtained legal agreement to extend the covenant on the redundant church so that it can be used for community and cultural events as well as being used as a burial chapel.

The Parish of Kingsley with Oakhanger has an electoral roll of 19. Attendance at both places of worship has sadly declined, with an average of 4 regular congregants in Kingsley. All Saints Church now has only one service a month, Holy Communion on the 4th Sunday of each month. With the decline of support for the church, previous regular events such as Lent Lunches, Harvest Suppers, Christmas Fetes etc are no longer possible to run.

The PCC has also declined in number with only 4 members, and All Saints has been without a church warden for several years.



Kingsley Pond

St Mary Magdalene, Oakhanger

Oakhanger is situated to the northeast edge of Selborne Parish. St Mary Magdalene is a small Church with a memorial garden to the front of the building, originally the village school in the mid 1800's. In 2012 a major restoration was completed with funds raised primarily from donations and grants. The congregation has diminished over recent years despite there being a very active and positive community within the village.

The centre of the village is arranged around the main road with its green, church and village hall. To the south of the village there is a large space satellite tracking station although this is not open to the public. There are a variety of property styles including thatched cottages together with a village pub 'The Hanger', previously known as 'The Red Lion', which underwent a total restoration and reopened in 2020. The village hall has also recently completed a major extension project, reopening in 2021 within Covid restrictions. Within the village are several flourishing businesses including a selection of holiday accommodation.

Oakhanger has a very active community with events held throughout the year including the Annual May Fayre and the August Village Show. To the north of the village lies Shortheath Common which is a nature reserve as well as being a Site of Special Scientific Interest (SSSI) and a Designated Special Area of Conservation (SAC). It covers some 143 acres containing heath, woodland, lake, pond and bog.



Setting up Noah's Ark in Froyle



Christingle Service in Bentley



The Binsted Real Nativity

Some of the Youth Work in Action



Church of England Primary Schools within the Benefice

Bentley Church of England Primary School

(www.bentleyprimaryschool.co.uk)

Headteacher: Mrs Katy Pinchess

Number of children: 188

Catchment area: Bentley and Froyle

2021 Ofsted report: Good with elements of Outstanding



Binsted Church of England Primary School

(www.binsted.hants.sch.uk)

Headteacher: Mrs Sharon Morton

Number of Children: 87

Catchment area: Binsted, Kingsley with Oakhanger

2018 Ofsted report: Good

Both Schools have strong links to their Churches.

The Rector is a governor of both schools and takes weekly assemblies and leads church visits from classes which form part of the RE curriculum.

A School Foundation Governor is drawn from the members of each church's Electoral Roll. Both schools use the churches several times a year – Christmas, Easter, Harvest and Remembrance.



Finances

Whilst we are still individual parishes, the finances of each PCC are therefore run separately. The annual budget is set by each PCC with fees and salaries being set by the Standing Committee of each PCC.

The Common Mission Fund contribution is paid in full each year by the parishes of Bentley, Binsted and Froyle. Due to the level of income, Kingsley with Oakhanger have not been paying their CMF contribution since 2018.

Bentley

Total Income & Total Expenditure, (2012-2021)

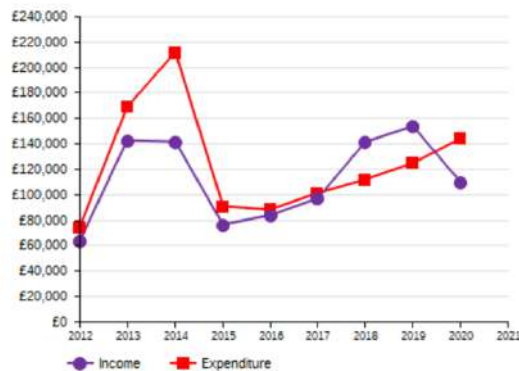

Income breakdown, (2012-2021)

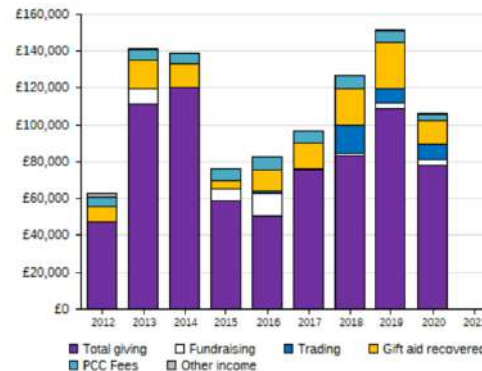

Expenditure breakdown, (2012-2021)

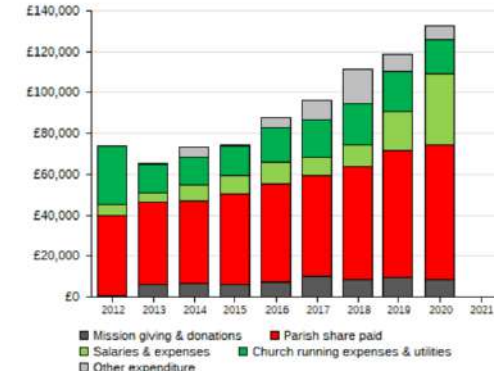

Binsted

Total Income & Total Expenditure, (2012-2021)

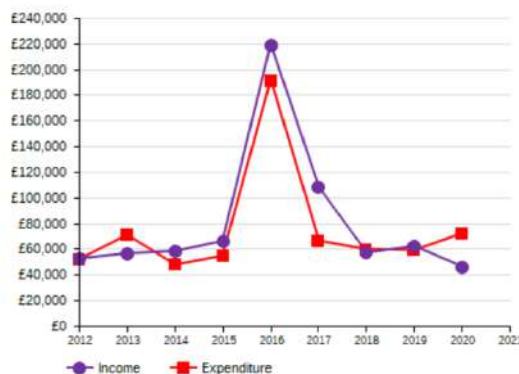

Income breakdown, (2012-2021)

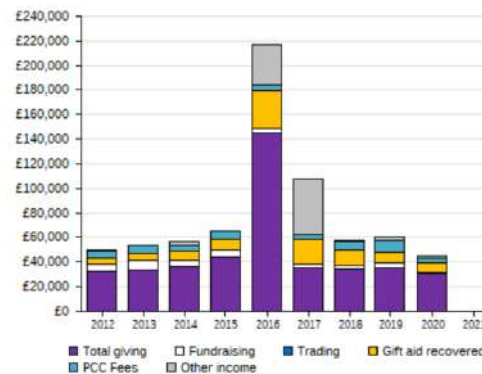

Expenditure breakdown, (2012-2021)

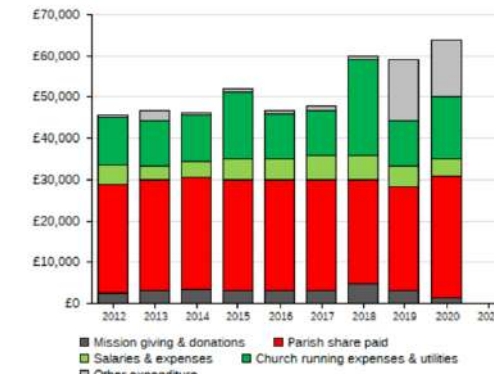

Froyle

Total Income & Total Expenditure, (2012-2021)

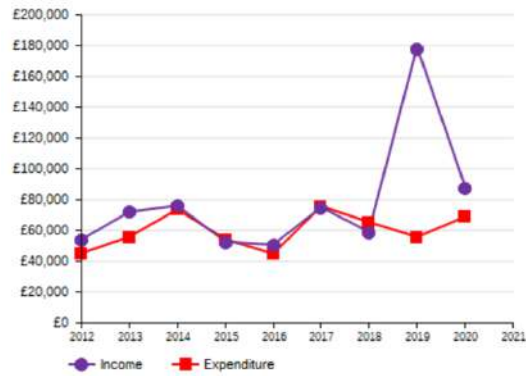

Income breakdown, (2012-2021)

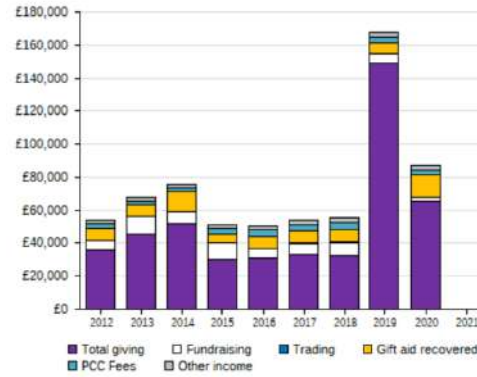

Expenditure breakdown, (2012-2021)

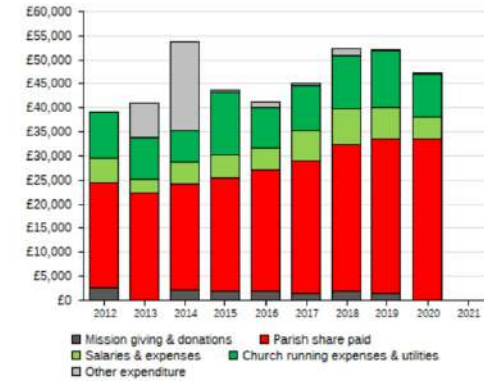

Kingsley with Oakhanger

Total Income & Total Expenditure, (2012-2021)

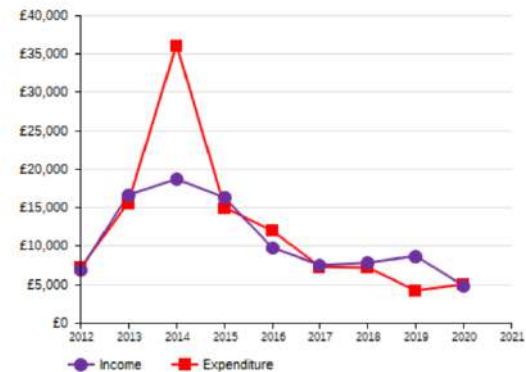

Income breakdown, (2012-2021)

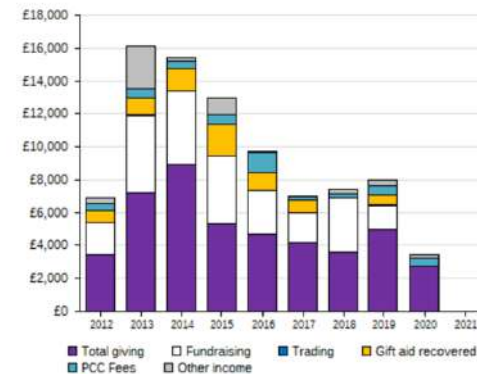

Expenditure breakdown, (2012-2021)

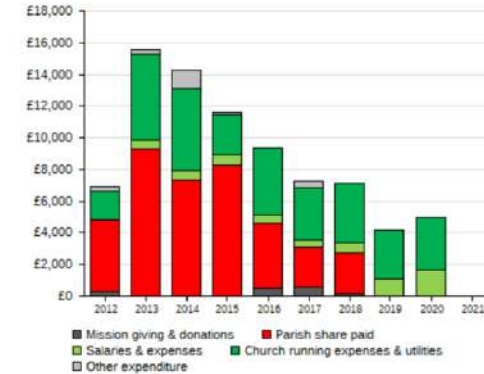

THE VICARAGE



Morning view from Vicarage

The present 4-bedroomed vicarage was built in the 1970s and is situated adjacent to Binsted church and in the centre of Binsted village. It has magnificent views over the countryside and is in walking distance of the village school. It is an attractive brick-built structure set back from the road and sheltered from passing traffic. It is orientated north/south with a south facing garden and has gas central heating.



The accommodation consists of the following:

- Ground floor: lobby with WC, entrance hall, study, living room (with working fireplace) which opens onto the terrace & garden with folding doors to the dining room, fitted kitchen with breakfast room and utility room.
- First floor: four bedrooms, family bathroom, dressing room and 2nd shower room.

At the rear of the house, to the south, there is a good-sized enclosed garden, with a gate through a hedge leading to the churchyard. In the front there is parking for approximately five/six cars, a garage and tool shed.

The house is serviced by gas, electricity, main drainage, and BT services.

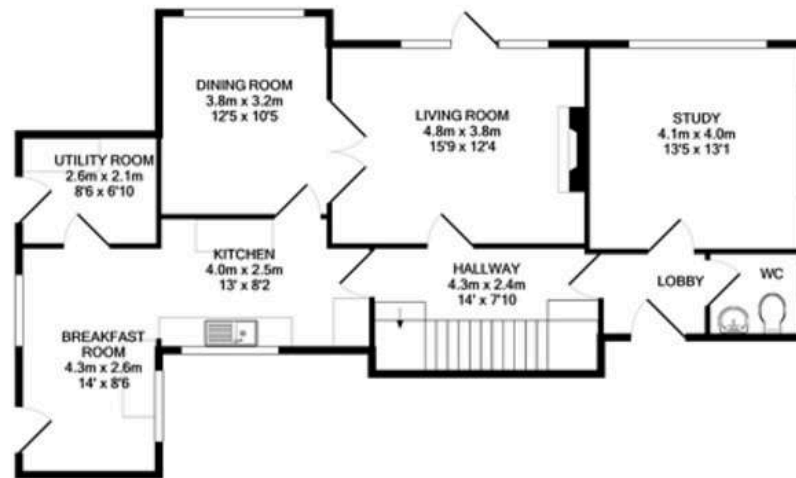

GROUND FLOOR
APPROX. FLOOR
AREA 88.0 SQ.M.
(947 SQ.FT.)



1ST FLOOR
APPROX. FLOOR
AREA 71.3 SQ.M.
(767 SQ.FT.)



Marquee Service



Men's Group Christmas Dinner



Confirmation Service



Christingle



Live@5 Tea



Passover Meal

Appendix:

Pattern of Services

BenBinFro and Kingsley with Oakhanger
Service Rota for Interregnum 2022

| | Week 1 | Week 2 | Week 3 | Week 4 | Week 5 |
|---------------|-----------------------------------|----------------------|--------------|------------------------|------------------|
| 8am | Froyle HC | | | | |
| 9.30am | Bentley MW + Children's Church | Binsted MW | Bentley HC | Binsted HC | |
| 11am | Oakhanger HC | Froyle HC | Froyle MP | Kingsley HC | Benefice Service |
| 4pm | | | Messy Church | | |
| 5pm | | Live@5 Big Praise | | Live@5 Yum Yum | |
| 6.30pm | | | | Froyle BCP Evensong | |

Services in dark green are normally lay lead

'From his fullness we have all received, grace upon grace.'
John 1:16

Diocesan Office, Wolvesey, Winchester SO23 9ND

t: 01962 737310 www.winchester.anglican.org



@CofEWinchester



www.facebook.com/CofEWinchester